

## Slide Switch SS Series

### SS13D01

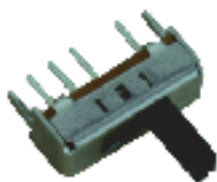

(SS-201B-13)

L=2 - 9

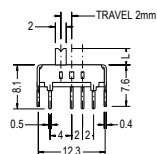
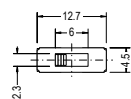

SCHEMATIC

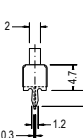

#### SPECIFICATION

- Circuit : ON-ON-ON(1P3T)
- Rating : D.C. 50V 0.3A
- Timing : Shorting

#### P.C.B. HOLE DETAIL

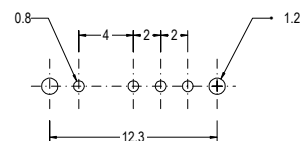

### SS13F06

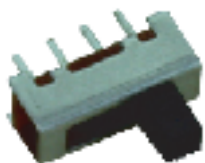

SCHEMATIC

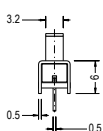
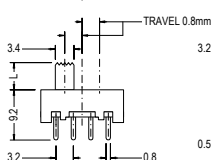
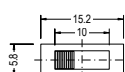

#### SPECIFICATION

- Circuit : ON-ON-ON(1P3T)
- Rating : D.C. 50V 0.5A
- Timing : Non Shorting

#### P.C.B. HOLE DETAIL

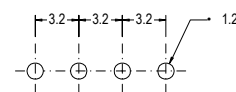

### SS13F24

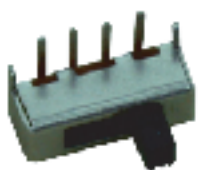

L=4 - 8

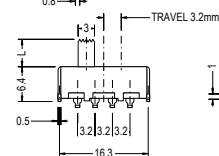
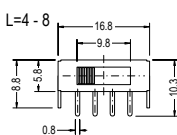

SCHEMATIC

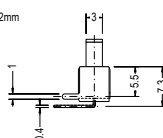

#### SPECIFICATION

- Circuit : ON-ON-ON(1P3T)
- Rating : D.C. 50V 0.5A
- Timing : Non Shorting

#### P.C.B. HOLE DETAIL

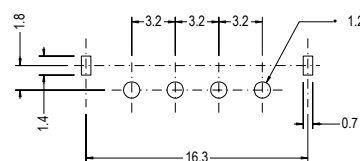

### SS16F03

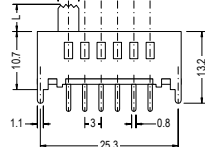
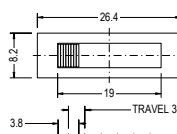
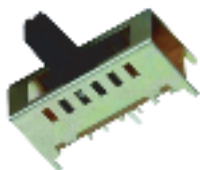

SCHEMATIC

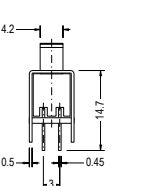

#### SPECIFICATION

- Circuit : ON-ON-ON-ON-ON-ON(1P6T)
- Rating : D.C. 50V 0.5A
- Timing : Shorting

#### P.C.B. HOLE DETAIL

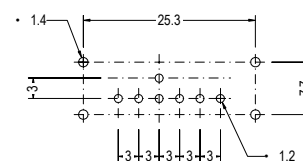

### SS22D03



L=2 - 6

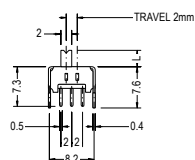
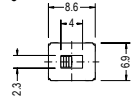

SCHEMATIC

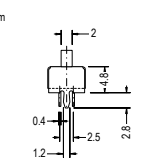

#### SPECIFICATION

- Circuit : ON-ON(2P2T)
- Rating : D.C. 50V 0.3A
- Timing : Non Shorting

#### P.C.B. HOLE DETAIL

