

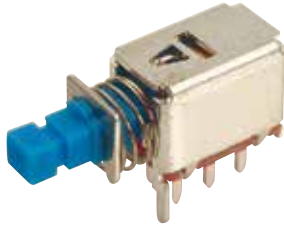

Push Button Switch M Series



Feature

- 1 A,30 V DC for Power Switch
- 2 Pole&4 Pole circuitry

Applications

- Home Electronic Equipment
- Industrial Electronic Equipment
- Audio System
- Adsl Modem
- Wireless AP

Specifications

SWITCH SPECIFICATIONS	
POLE - POSITION	1P2T , 2P2T , 4P2T , Momentary and Lock Type are available
CONTACT RATING	30 V DC , 0.3 A ; 30 V DC , 1 A
CONTACT RESISTANCE	50 mΩ max . 1.5 V DC ; 100 mA , by Method of Voltage DROP
INSULATION RESISTANCE	100 MΩ min . 500 V DC
DIELECTRIC STRENGTH	Breakdown is not Allowable ; 500 V AC for 1 Minute
OPERATING FORCE	1P2P - 200 ± 150gf ; 2P2T - 300 ± 150gf ; 4P2T - 300 ± 150fg
OPERATING LIFE	10,000 cycles
OPERATING TEMPERATURE RANGE	-20°C ~ 70°C
TOTAL TRAVEL	2.5 ± 0.3 mm

How To Order

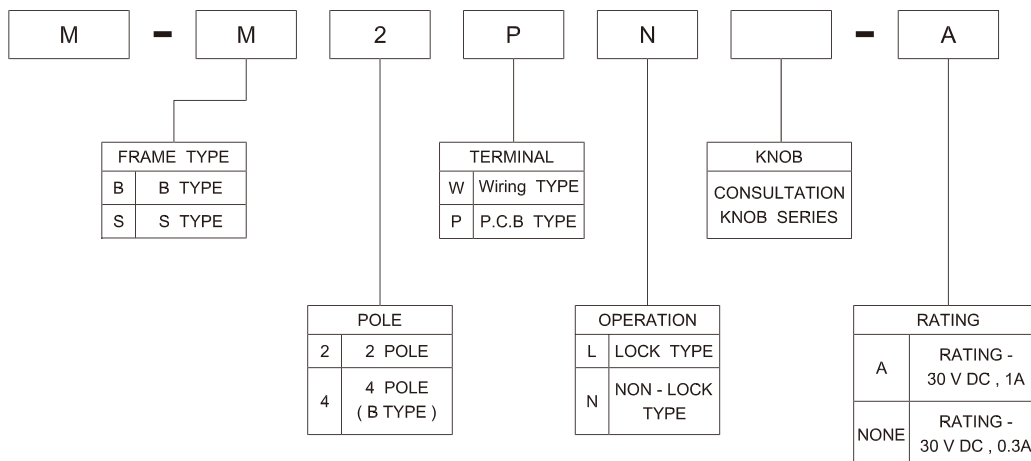



Frame Type & Terminal Type

S TYPE

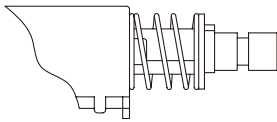

B TYPE

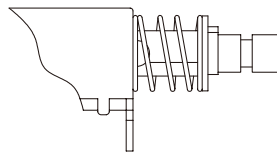

TERMINAL TYPE

W TYPE

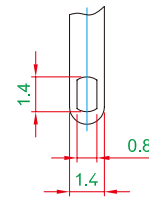

P TYPE

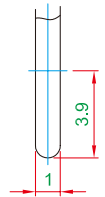

Dimensio

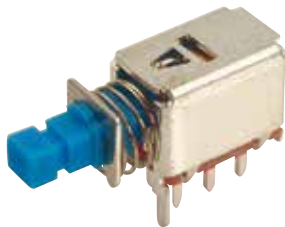

M - B2PN

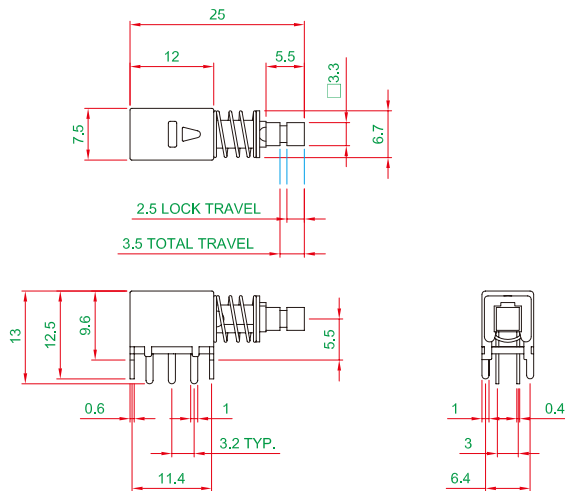

Schematic

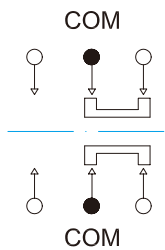

P.C.B Layout

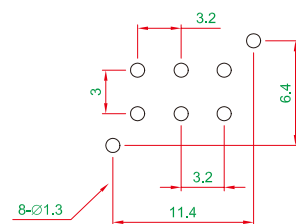



Dimension

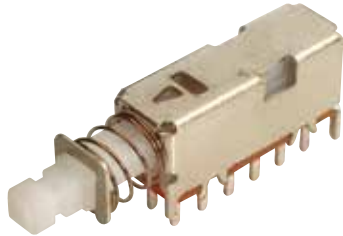

M - B4PN

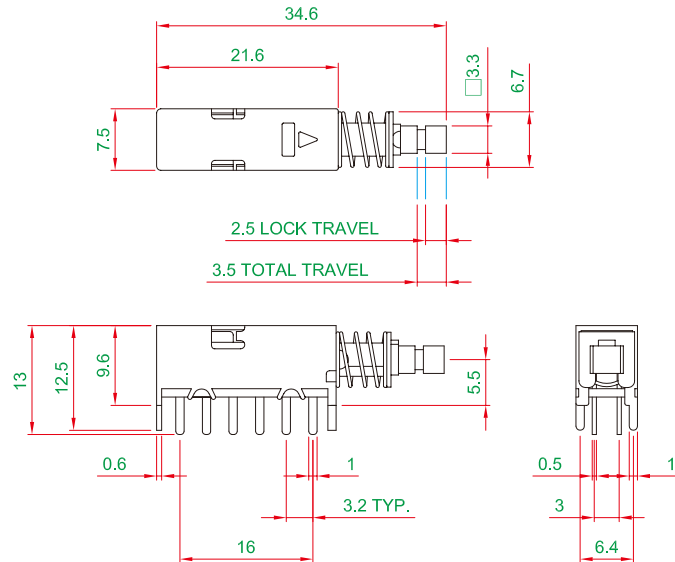

Schematic

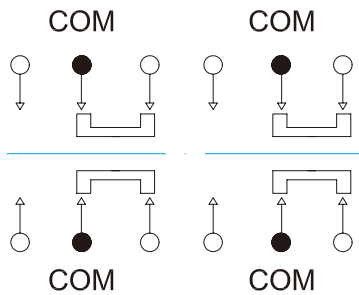

P.C.B Layout

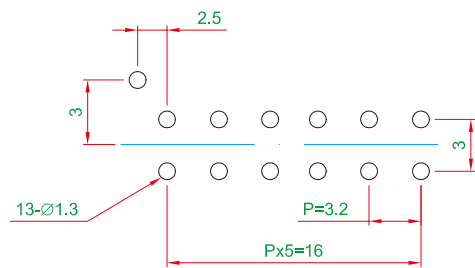

Material

- ACTUATOR - POM
- TERMINAL - BRONZE SILVER PLATING
- FRAME - STEEL PLATE , TIN PLATING
- SPRING - STAINLESS STEEL

Unit Weight

- M - M2WL : 2.6 ± 0.05 g / pcs
- M - H2PN : 2.5 ± 0.05 g / pcs
- M - B2PL : 2.5 ± 0.05 g / pcs
- M - S2PL : 2.4 ± 0.05 g / pcs
- M - W2WL : 2.9 ± 0.05 g / pcs